

S&G® Titan™ Direct Drive Electronic Safe Lock

Advanced Design Direct Drive Electronic Safe Lock



Why S&G® Titan™?

- Completely redesigned locking mechanism based on the proven security of a rugged, motorized blocking device.
- Lock bolt retraction and extension is controlled directly by turning the keypad ring.
- Attach boltwork or a blocking bar directly to the lock bolt or to optional locking bars without fear of overwhelming the lock's drive mechanism or accelerating wear.

The Titan™ Direct Drive Advantage:

- An exclusive, no-twist cable design that virtually eliminates the risk of cable damage due to keypad rotation.
- Sure-grip, low profile keypad gives a good, solid feel for the action of the lock.
- Underwriters Laboratories Type 1 Listing and several additional international agency ratings.

- Low profile keypad incorporates an open/close indicator to let you know at a glance if the safe is locked or unlocked.
- External battery placement puts the battery inside the keypad, where it can be easily changed. And efficient lock design means the battery must be changed significantly less often.
- Field installable bolt position indicator (BPI) module is available to let you tie lock action to alarms, video surveillance recorders, etc. The module can be added to a lock at any time, with minimal labor.
- Program the lock from the keypad at any time.
- The S&G® Titan™ lock body is the same size and mounting footprint as other standard S&G locks, allowing for easy retrofit without the need for boltwork or mounting screw location changes. Plus, it's universally handed for RH, LH, VU, and VD mounting.



STANLEY, STANLEY in a notched rectangle, SARGENT AND GREENLEAF, S&G, and TITAN are some of the trademarks of The Stanley Works or its affiliates.
UL and UL in a circle are trademarks of Underwriters Laboratories.
Patent Pending.

630-812 Rev 6/15/2010
© 2010 Sargent & Greenleaf, Inc.



Titan™ D-Drive by Sargent and Greenleaf

Advanced electronic technology and positive bolt control

CHOOSE YOUR OPTIMUM MODE THROUGH THE KEYPAD

The Titan™ D-Drive lock is rated by several international security agencies and is UL Type 1 Listed. In addition, it's RoHS compliant.



Three Keypad Selectable Modes of Operation —

- Multi-User—The Master Code, Supervisor Code, and any User Code can open the lock with a single code.
- Manager/Employee—Code holders can access the safe only when it's been enabled by a Master Code or Supervisor Code holder.
- Dual Control—Multi-User mode is the factory default, but Dual Control is keypad selectable as an alternate, permanent mode of operation. Two different lock codes must be entered within one minute of each other to open the safe. This provides a higher level of security.

Multiple Codes —

- One Master Code, one Supervisor Code, eight User Codes*, one Time Delay Override Code, and a Management Reset Code.

Holdup Protection —

- Time delay is a proven holdup deterrent. The S&G® Titan™ D-Drive lock gives you a time delay up to 99 minutes, and a time delay override code for instant cash carrier access.

* When a time delay override code is set, the number of available user codes is seven. If the lock is set to multiple user mode and duress is turned on, only User Codes 2 and 3 are available. User Codes 4 – 8 are disabled. User Code 9 will be available to use if time delay override is not enabled. Loss of User Codes when duress is enabled is required to meet EN1300 specifications for this product. If the lock is set to dual user mode, all codes always remain available.



Optional Bolt Position Indicator (BPI) module can trigger alarms, CCTV recorders, or virtually any relay activated security device.



The lock cable is completely protected in a specially designed channel in the spindle. It can't get caught, pinched, or crimped as the lock is operated day after day.



The lock battery is housed in a special compartment inside the keypad, where it can be easily accessed for changing.

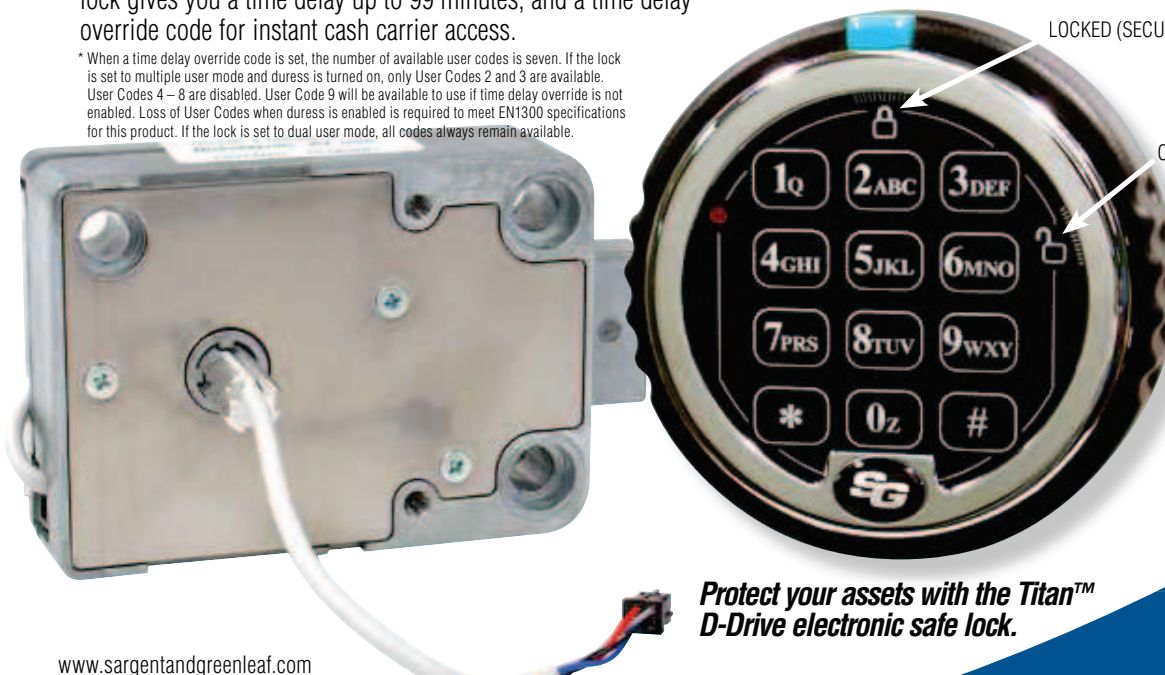

LOCKED (SECURE) INDICATOR

OPEN INDICATOR

Sure-grip, low profile keypad incorporates OPEN and CLOSE indicators. You can tell at a glance whether your lock is open or secure.

Protect your assets with the Titan™ D-Drive electronic safe lock.

www.sargentandgreenleaf.com

Corporate Headquarters: One Security Drive • Nicholasville, Kentucky 40356 • USA • Tel. 859-885-9411, Fax 859-887-2057

European Headquarters: 9, chemin du Croset • 1024 Ecublens • Switzerland • Tel. 41 21 694 34 00, Fax 41 21 694 34 09

